



RESTAURANT FOR LEASE

236 WINTER STREET
KEYSTONE, SD 57751

FOR LEASE \$65,000 OR 10% OF SALES



PROPERTY OVERVIEW

Located in the heart of historic Keystone, across from Quality Inn, this space is situated in a high-traffic area, perfect for attracting both tourists and locals alike. The inviting outdoor patio area offers additional seating for guests. With its prime location, ample parking, and a steady stream of foot traffic (3 millions visitors per year), this space presents a unique opportunity for a successful restaurant venture. Includes some kitchen equipment, 4x8 hood, glass display, and beer tap.

2,700 SF

KW Commercial

Your Property—Our PrioritySM

2401 West Main Street, Rapid City, SD 57702
605.335.8100 | www.RapidCityCommercial.com
Keller Williams Realty Black Hills

EXCLUSIVELY LISTED BY:

Chris Long, SIOR, CCIM

Commercial Broker

605.939.4489

chris@rapidcitycommercial.com

Gina Plooster

Leasing Agent

605.519.0749

gina@rapidcitycommercial.com

Disclaimer: The information contained herein has been given to us by the owner of the property or other sources we deem reliable. We have no reason to doubt its accuracy, but we do not guarantee it. All information should be verified prior to purchase or lease.

FLOORPLAN

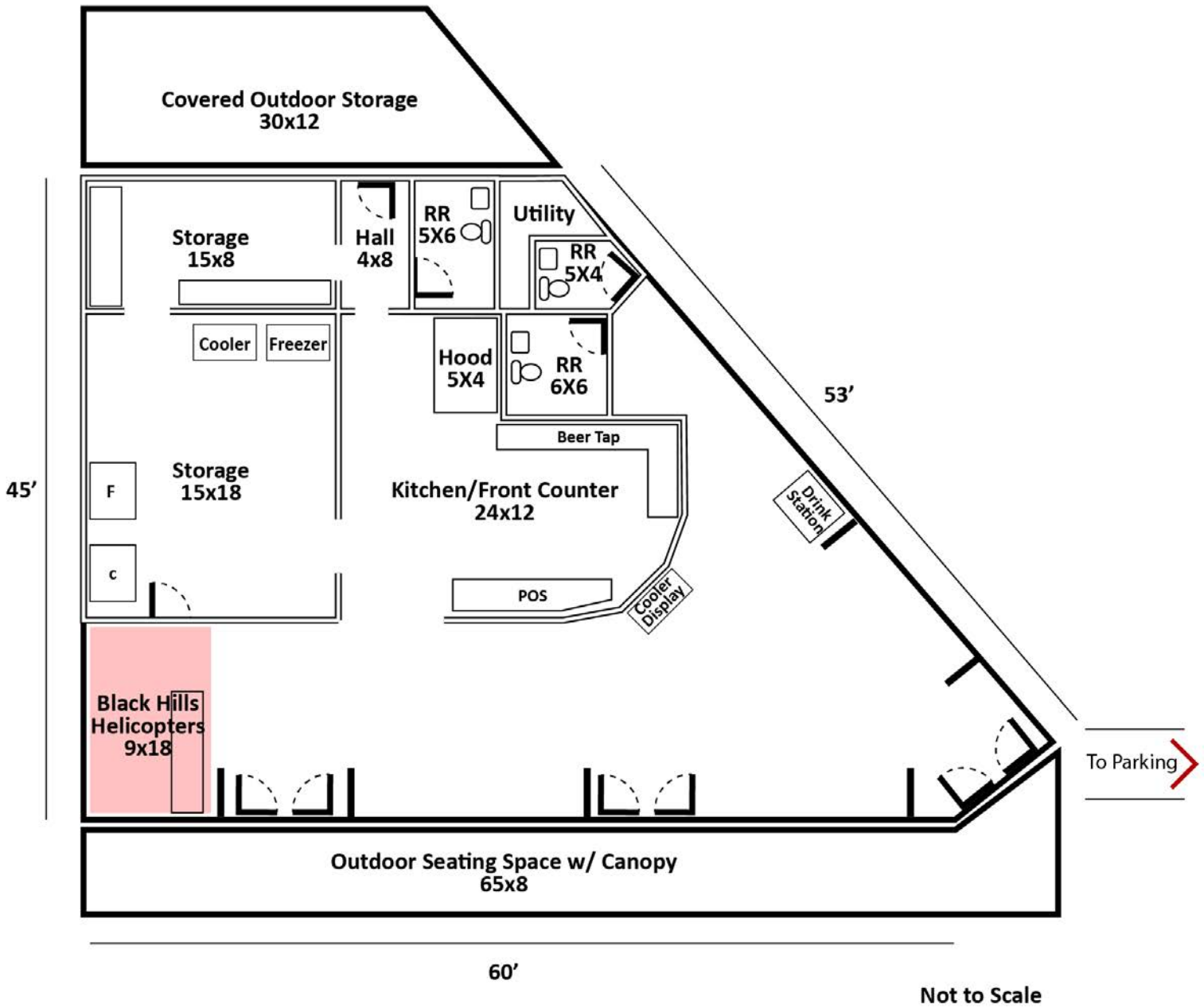

EXCLUSIVELY LISTED BY:

Chris Long, SIOR, CCIM
Commercial Broker
605.939.4489
chris@rapidcitycommercial.com

Gina Plooster
Leasing Agent
605.519.0749
gina@rapidcitycommercial.com

PHOTOS



STATISTICS

**WELCOME TO SOUTH DAKOTA
AND THE BLACK HILLS!**

The Mount Rushmore State of South Dakota has carved a solid reputation for business friendliness. It is consistently ranked in the top five states for setting up and conducting business. Small and big companies alike are discovering South Dakota's central location and progressive business climate.

The Black Hills boasts the country's most recognized national monument - Mt. Rushmore - bringing millions of tourists from all over the world to Western South Dakota every year. For the past 9 years, South Dakota tourism has posted an increase in visitation, visitor spending and overall impact on the state's economy with 14.4 million visitors to South Dakota, \$4.7 billion in visitor spending, and 56,826 jobs sustained by the tourist industry.



BUSINESS FRIENDLY TAXES

NO corporate income tax	NO franchise or capital stock tax	NO personal property or inventory tax
NO personal income tax	NO estate and inheritance tax	

REGIONAL STATISTICS

Rapid City PUMA Population	189,754
Rapid City Population Growth	1.46% YoY
Rapid City Unemployment Rate	2.3%
PUMA Median Income	\$57,977

SD TOURISM 2021

Room nights	↑	33%
Park Visits	↑	11%
Total Visitation	↑	28%
Visitor Spending	↑	28%

RAPID CITY

- #1 Outdoor Life—Best hunting and fishing town
- #4 CNN Money—Best Place to Launch a Business
- #4 Wall Street Journal—Emerging Housing Markets
- #4 WalletHub—Best Places to rent
- #11 Forbes—Best Small City for Business
- #16 Top 100 Best Places to Live

SOUTH DAKOTA

- #1 Best State for Starting a Business
- #1 America's Friendliest State for Small Business
- #2 Best State for Small Business Taxes
- #2 Best Business Climate in the US
- #2 Best State for Quality of Life
- #2 Best State for Overall Well-Being and Happiness
- #2 Business Tax Climate by the Tax Foundation
- #3 US News Fiscal Stability 2019 list
- #3 Small Business Policy Index 2018 list